

Storage Cabinet

1560-GS



MN-47210

REV.01
11/20

EN



Manufacturer's Information

Copyright

© Copyright 11/20 by Enthermics Medical Systems.

All rights reserved.

This manual or any portion thereof may not be reproduced or used in any manner whatsoever without the express written permission of Enthermics Medical Systems.

Trademarks

All trademarks referenced in this documentation are the property of their respective owners.

Manufacturer



Enthermics Medical Systems

An ISO 13485:2016 certified company

W164 N9221 Water Street

Menomonee Falls, WI 53051, USA

Original instructions

The content in this manual is written in American English.

Service Parts

For Service Parts, contact Enthermics Medical Systems at 800-558-8744.

Manufacturer's Information	2
Safety	5
The Meaning of Signal Words	5
Safety Precautions.	6
Labels	7
Specifications	9
Specification Information	9
Dimension Drawings	10
Installation	15
How to Unpack the Storage Cabinet	15
How to Install the Storage Cabinet	16
Maintenance	19
Preparing the Storage Cabinet for First Use	19
How to Clean the Storage Cabinet	20
Storage Cabinet Disposal / Decommissioning	21
Warranty	23
Warranty	23

TABLE OF CONTENTS

This page intentionally left blank.

The Meaning of Signal Words

This manual contains signal words where needed. These signal words must be obeyed to reduce the risk of death, personal injury, or equipment damage. The meaning of these signal words is explained below.

**DANGER**

Danger indicates a hazardous situation which, if not avoided, will result in serious injury or death.

**WARNING**

Warning indicates a hazardous situation which, if not avoided, could result in serious injury or death.

**CAUTION**

Caution indicates a hazardous situation which, if not avoided, could result in minor or moderate injury.

NOTICE

Notice indicates a situation which, if not avoided, could result in property damage.



NOTE: Note indicates additional information that is important to a concept or procedure.

Safety Precautions

Before you begin

Read and understand all instructions in this manual.

Usage precautions

Obey these usage precautions when using the storage cabinet:

- Do not overload the storage cabinet.
 - Do not use corrosive chemicals when cleaning the storage cabinet.
 - Do not remove exterior panels from the storage cabinet or attempt repairs. The storage cabinet has no user-serviceable internal components. Only perform routine cleaning and maintenance procedures specifically described in this manual. Inspection and servicing of internal components must only be performed by qualified service personnel.
 - Only a qualified Enthermics service representative may make modifications to the storage cabinet. Modifications to the storage cabinet could be hazardous to users and patients.
-

Condition of the storage cabinet

Only use the storage cabinet when:



- The storage cabinet is installed correctly.
 - The shelves are installed correctly.
 - The storage cabinet is clean.
 - The storage cabinet labels are legible.
-

Servicing the storage cabinet

- Obey precautions in the manual, on tags, and on labels attached to or shipped with the storage cabinet.
 - Only trained personnel are permitted to service or repair the storage cabinet. Repairs that are not performed by a trained technician, or the use of non-factory parts, will void the warranty and relieve all liability.
 - Any troubleshooting guides and components views included with this manual are for reference only and are intended for use by qualified and trained service technicians.
 - To prevent serious injury, death or property damage, have the storage cabinet inspected and serviced at least every twelve (12) months by a trained technician.
 - Contact Enthermics for the authorized service partner in your area.
-

Incident notice

- Any serious incident that has occurred in relation to the storage cabinet should be reported to the manufacturer and the competent authority of the Member State in which the user and/or patient is established.

<p>—</p>	 <p>QUALITY INSPECTED</p> <p>INSPECTORS INITIALS _____</p> <p>DATE _____</p> <p>www.enthermics.com/quality LA-36649</p>	<p>Quality inspected</p>
<p>—</p>		<p>CAUTION</p> <p>Mount the storage cabinet to the floor before use. (label installed on leg of unit)</p>

This page intentionally left blank.

Specification Information

Model	1560-GS
Intended use	General storage
Weight	Net: 190 lb (86 kg) Ship: 250 lb (113 kg)
Storage cavity capacity	15.6 ft ³

Transportation and storage conditions

- Ambient temperature range of -40°F to +159°F (-40°C to +70°C).
- Relative humidity range of 10% to 95%, non-condensing.
- Atmospheric pressure range of 7.25 psi to 15.37 psi (50kPa to 106kPa).

SPECIFICATIONS

Dimension Drawings

1560-GS Reach-In

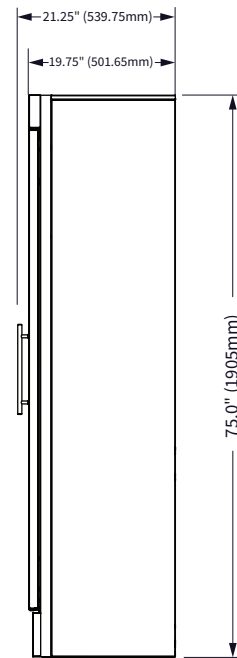
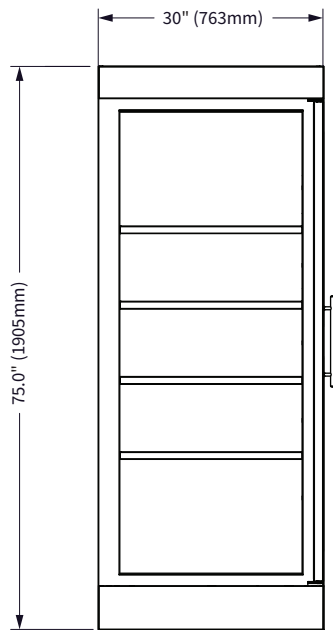
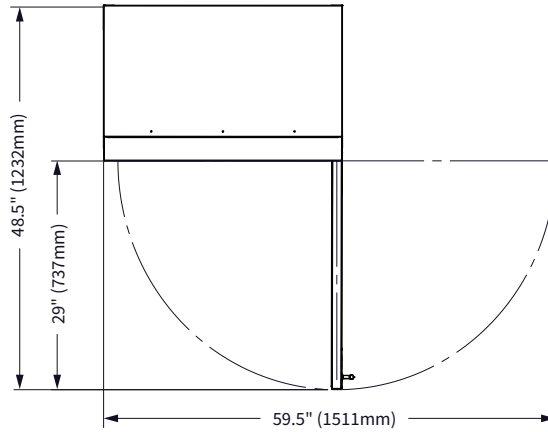

EC-DIM-011414

1560-GS Pass-Through

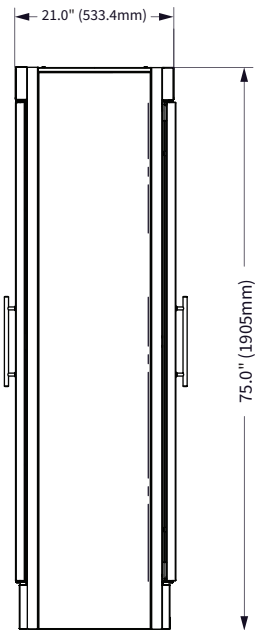
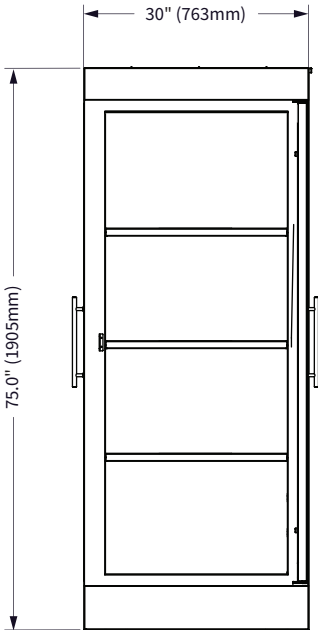
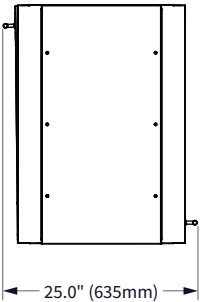
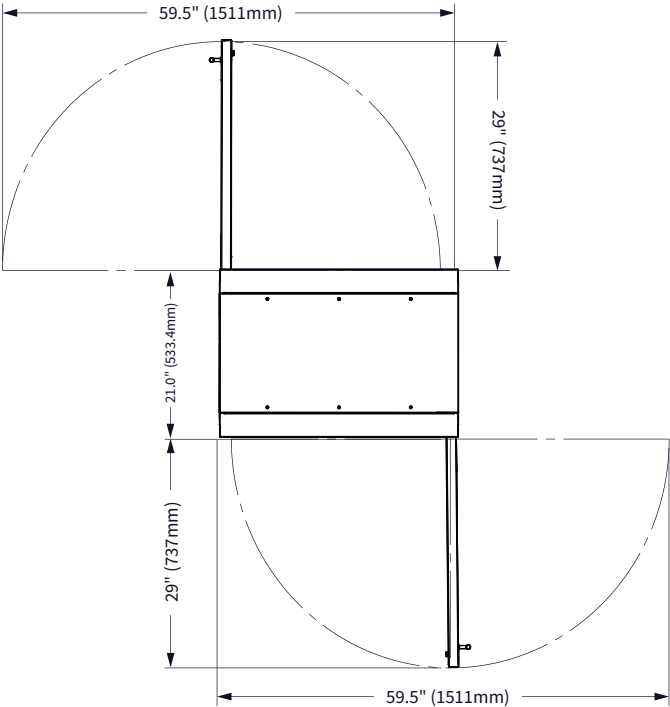

EC-DIM-011420

1560-GS Built-In

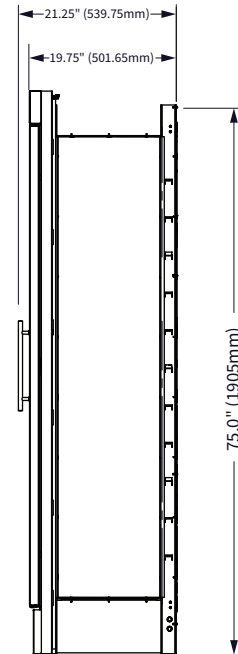
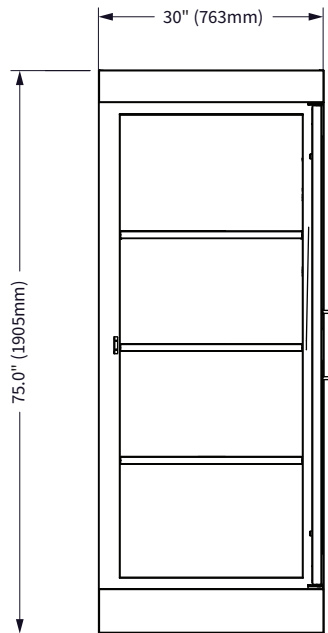
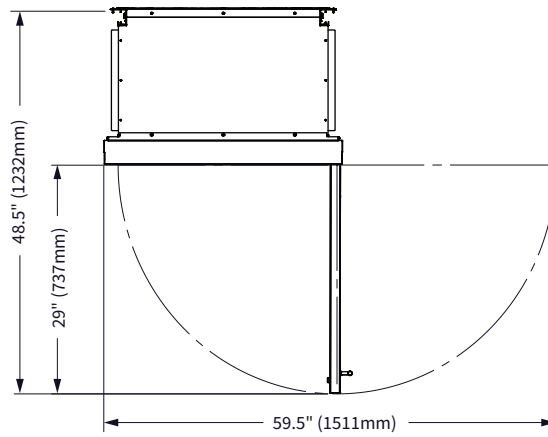

EC-DIM-011423

1560-GS Built-In Cutout Specifications

Cutout Specifications	
Height	74.5" (1892.25mm)
Width	29.25" (743mm)
Depth	17" (432mm)

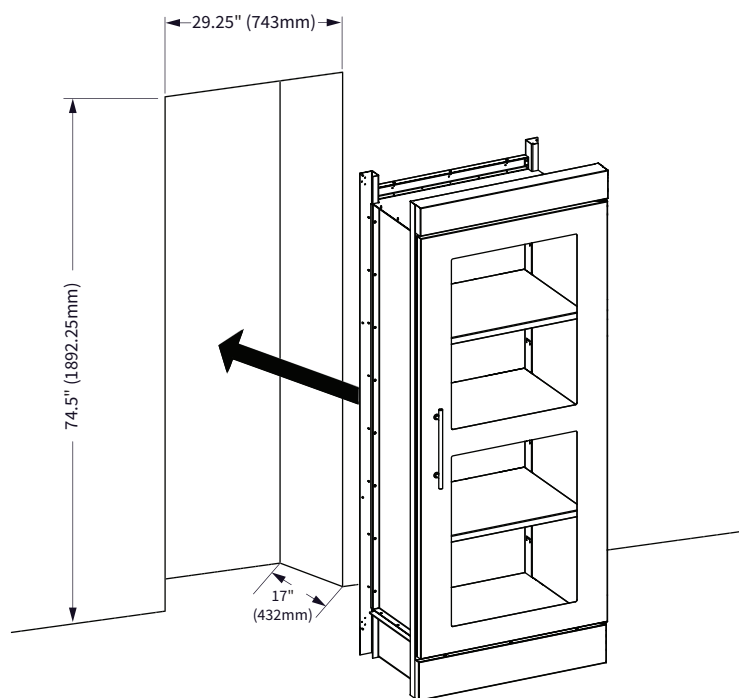

EC-DIM-011429

This page intentionally left blank.

How to Unpack the Storage Cabinet



WARNING: Crushing hazard.

An unstable storage cabinet can lead to a crushing hazard. Observe your facility's best practices for moving large equipment.



Before you begin

Make sure you have:

- Reviewed the storage cabinet specifications.
- An appropriate lifting device and enough personnel to safely move and position the weight of the storage cabinet.
- Cutting tools to remove the packaging.

Unpack the storage cabinet

To unpack the storage cabinet, do the following.

Step	Action
1.	Remove the box or crate. Save all packing materials for inspection by the carrier. <div>  NOTE: Examine the storage cabinet for damage. If the storage cabinet has been damaged, do not use the storage cabinet until it has been inspected by an authorized service provider. Contact your carrier or customer service. </div>
2.	Cut and remove the retaining straps and plastic wrap.
3.	Remove the storage cabinet from the pallet using an appropriate lifting device.
4.	Remove the paperwork from the cavity.
5.	Open the accessories box and install the shelf clips and shelves into the cavities. <div>  NOTE: Set aside the toe panel(s) and screws. The toe panel(s) and screws will be used during installation after mounting the storage cabinet. </div>

Result

The storage cabinet is now unpacked.

How to Install the Storage Cabinet



WARNING: Tipping hazard.
Mount the storage cabinet to the floor before use.

Before you begin

Make sure you have:

An appropriate lifting device and enough personnel to safely move and position the weight of the storage cabinet.

Requirements

The storage cabinet must be installed on a level surface.

Position the storage cabinet

To position the storage cabinet, do the following.

Step	Action
1.	Make sure that: <ul style="list-style-type: none"> ■ The location where the storage cabinet is being installed is rated to support the weight of the storage cabinet; ■ You reference the built-in specification page for cutout dimensions.
2.	Move the storage cabinet to the installation location and onto the final resting surface.

The storage cabinet is now correctly positioned.

Continued on next page

Continued from previous page

Mount the storage cabinet to floor

To mount the storage cabinet to the floor, do the following.



WARNING: Tipping hazard.
Mount the storage cabinet to the floor before use.

3. **Bolt** the storage cabinet to the floor.

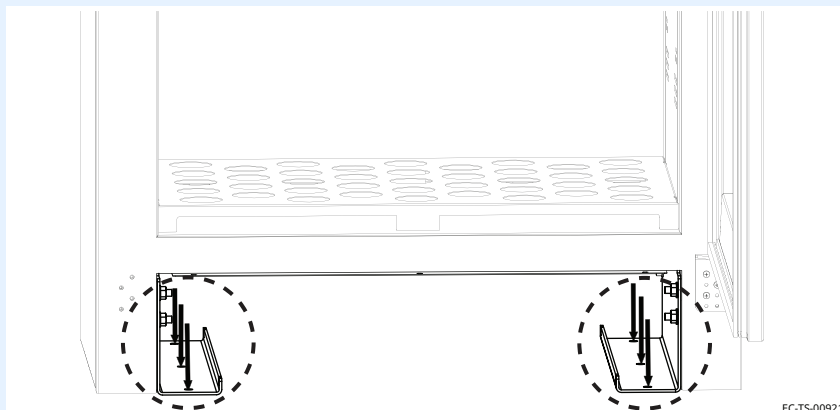

4. **Install** the toe panel.

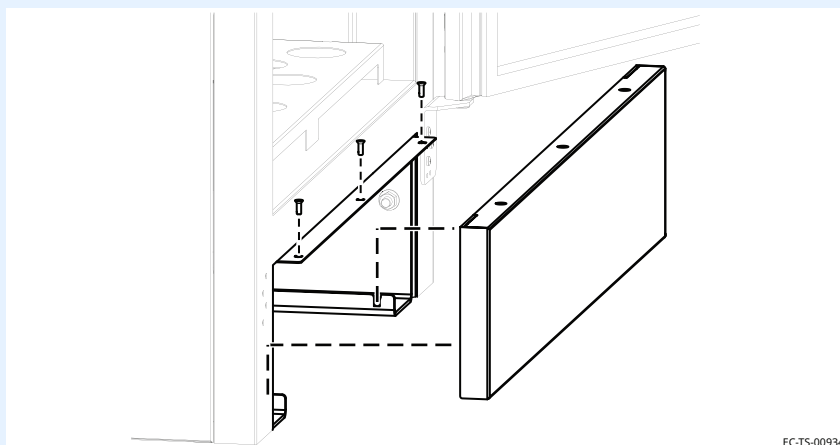

Result

The storage cabinet is now installed and ready to be used.

This page intentionally left blank.

Preparing the Storage Cabinet for First Use

Before you begin

NOTICE

Do not use:

- abrasive cleaning compounds.
- chloride based cleaners.
- commercial or household cleaners containing ammonia.

Approved cleaning agents

- 70% or greater isopropyl alcohol
- PDI Sani-Cloth® HB

Procedure

To prepare the storage cabinet for first use, do the following.

Step	Action
1.	Wipe the outside of the storage cabinet: <ul style="list-style-type: none"> ■ with a stainless steel cleaner, if stainless steel panels. ■ with an approved cleaning agent, if painted panels.
2.	Clean the interior of the storage cabinet with a damp cloth or approved cleaning agent.
3.	Dry the interior and exterior of the storage cabinet with a clean, lint-free cloth. Leave the door open until the interior of the storage cabinet completely dries.
4.	Clean each side of the window pane with glass cleaner or distilled vinegar.

Result

The storage cabinet is now ready for first use.

How to Clean the Storage Cabinet

Before you begin



WARNING: Crushing hazard.

An unstable storage cabinet can lead to a crushing hazard. Observe your facility's best practices for moving large equipment.

NOTICE

Do not use:

- abrasive cleaning compounds.
- chloride based cleaners.
- commercial or household cleaners containing ammonia.

Approved cleaning agents

- 70% or greater isopropyl alcohol
- PDI Sani-Cloth® HB

Monthly cleaning procedure

To clean the storage cabinet monthly, do the following.

Step	Action
1.	Wipe the outside of the storage cabinet with a stainless steel cleaner.
2.	Clean the interior of the storage cabinet with a damp cloth or approved cleaning agent.
3.	<p>Dry the interior and exterior of the storage cabinet with a clean, lint-free cloth.</p> <p>Leave the door open until the interior of the storage cabinet completely dries.</p>
4.	Clean each side of the window pane with glass cleaner or distilled vinegar.

Continued on next page

Continued from previous page

Yearly cleaning procedure

To clean the storage cabinet yearly, do the following.

Step	Action
1.	Remove the shelves from the interior of the storage cabinet.
2.	Clean the shelves and interior with a damp cloth or approved cleaning agent.
3.	Dry the interior of the storage cabinet with a clean, lint-free cloth. Leave the door open until the interior of the storage cabinet completely dries.
4.	Clean each side of the window pane with glass cleaner or distilled vinegar.
5.	Re-install the shelves.

Result

The storage cabinet is now clean.

Storage Cabinet Disposal / Decommissioning

This product and its accessories must be disposed of according to local laws and regulations. Do not dispose of this product as unsorted municipal waste.

This page intentionally left blank.

Warranty

Introduction

Enthermics Medical Systems warrants to the original purchaser only, that any original part found to be defective in material or workmanship will be replaced with a new or rebuilt part at Enthermics option, subject to provisions hereinafter stated.

Warranty Period

The warranty period is as follows:

- For storage cabinets shipped to the United States or Canada,
 - The original parts warranty remains in effect for one (1) year from the shipping date. This excludes the glass doors unless damage occurs during shipping.
- To be valid, a warranty claim must be asserted during the applicable warranty period. This warranty is not transferable.

Exclusions

This warranty does not apply to:

- Equipment damage caused by accident, shipping, improper installation or alteration.
- Equipment used under conditions of abuse, misuse, carelessness or abnormal conditions, including but not limited to, equipment subjected to harsh or inappropriate chemicals, including but not limited to, compounds containing chloride or quaternary salts, poor water quality, or equipment with missing or altered serial numbers.
- Any losses or damage resulting from malfunction, including the loss of contents or consequential or incidental damages of any kind.
- Equipment damage caused by use of any cleaning agents other than those recommended by Enthermics, including but not limited to damage due to chlorine or other harmful chemicals.
- Equipment modified in any manner from original model, substitution of parts other than factory authorized parts, unauthorized removal of any parts including legs, or unauthorized addition of any parts.
- Collateral or incidental damage as a direct result of servicing equipment built into a wall structure is not covered under warranty. It is the responsibility of the owner to bear all expense related structural repairs including, but not limited to, external electrical connections and wiring, and the removal or replacement of caulk, grout, tile, or wall covering of any kind. A service access panel for built-in equipment installations is strongly recommended.

Conclusion

This warranty is exclusive and is in lieu of all other warranties, express or implied, including the implied warranties of merchantability and fitness for a particular purpose. No person except an officer of Enthermics is authorized to modify this warranty or to incur on behalf of Enthermics any other obligation or liability in connection with Enthermics equipment.

WARRANTY



Printed in the U.S.A.

Specifications are subject to change without notice.

Enthermics Medical Systems

An ISO 13485:2016 certified company
W164 N9221 Water St
Menomonee Falls, WI 53051
262-251-8356 | 800-TO-B-WARM
generalinfo@enthermics.com
www.enthermics.com

Made in the U.S.A